

Gadlee®

GTV-10D

Vacuum Cleaner / 吸尘器

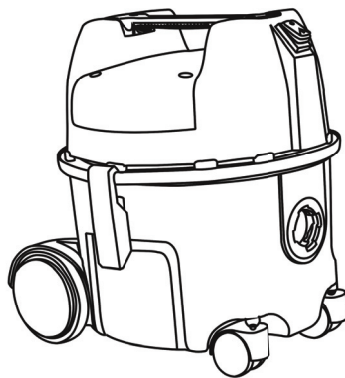

OPERATOR'S MANUAL/操作说明书



READ THE BOOK



请仔细阅读说明书

English (5-8)

中文 (1-4)

This book has important information for the use and safe operation of this machine. Failure to read this book prior to operating or attempting any service or maintenance procedure to your Gadlee machine could result in injury to you or to other personnel; damage to the machine or to other property could occur as well. You must have training in the operation of this machine before using it. If your operator(s) cannot read this manual, have it explained fully before attempting to operate this machine.

All directions given in this book are as seen from the operator's position at the rear of the machine.

本说明书内有机器使用及安全操作的重要信息。在对机器进行任何操作或者维护之前，请务必仔细阅读本说明书，否则会引致机器及其他物件的损坏，甚至会引致使用者或其他人员伤亡。在使用本机器前，操作员必须接受培训及获得认可。如果操作员不能阅读本说明书，操作员必须在获得充分解释后才能尝试使用机器。本说明书提及的方向都是根据操作员在机器后方而指出的。

1. 注意事项

在启动和使用机器前，或者进行维护和操作前，请先认证阅读“注意事项”。

- 1.1 本设备不适合由体能弱、反应迟缓或有精神障碍的人（包括儿童）操作，除非在对其负有安全责任的人员指导或帮助下安全使用。
- 1.2 儿童应被监督，以保证他们不玩耍器具。
- 1.3 清洁或维修器具时，务必将电源插头从插座中拔出。
- 1.4 当电源软线有损坏或松脱时，应由制造商的服务机构或具有资格的人来更换电源线。
- 1.5 停机后要把电源线插头拔掉。
- 1.6 使用与器具电压、频率匹配的电源。

2. 操作说明

在对机器进行任何操作之前，请先认真阅读本“操作说明”。

2.1. 使用说明

- 2.1.1 确定电源电压与本机相同。
- 2.1.2 接驳所有喉管后，应选择适当吸扒。
- 2.1.3 将吸尘管接驳到吸尘机吸嘴。
- 2.1.4 切记请将电源线安放在机身吸嘴后方。

2.2. 吸尘使用方法

- 2.2.1 吸水前请取去灰尘过滤器。
- 2.2.2 请取去圆桶内什物。
- 2.2.3 吸地毯时，桶内应加上消泡剂，防止泡沫吸入电机内，导致马达烧坏。
- 2.2.4 如果马达进水使电机烧坏，不属保修范围。

2.3. 清洁保养

- 2.3.1 清洁圆桶，切勿让任何污垢，积聚在圆桶内。
- 2.3.2 彻底清洁洗擦吸尘袋。
- 2.3.3 检查电源线，确保电源线没有损坏。
- 2.3.4 用清洁剂加温水清洗吸尘袋需吹干后方可重新使用。
- 2.3.5 吸尘袋每3-6个月需更换。

2.4. 马达保养

吸尘机马达内的碳刷需每年由服务人员检查一次。

3. 技术信息

- 性能特点

本机具有轻巧灵活、超静音设计、吸力强劲、多用途的随机附件，组装方便，适用于家居、会所、车间、厂房、写字楼及其他大型公共场所使用。

- 实物图



GTV-10D

- 技术参数

型号	GTV-10D	真空吸力	2380mmh ₂ O
容量	10L	冷却模式	循环风冷
工作电压	220V	桶身直径	345mm
功率	1000W	高度	400mm
功能	吸尘器	配件	Φ32
气流量	210m ³ /h	电线	7m

*厂方有权修改技术参数无需事先通知

- 标准配件



4. 分解图



5. 电路图

在进行任何维护前，请务必断开机器主电源。
所有有关电器部分的保养维护，必须由经过认证及培训的专业人员进行，并必须遵守安全规则及说明书的指引。

！ 危险

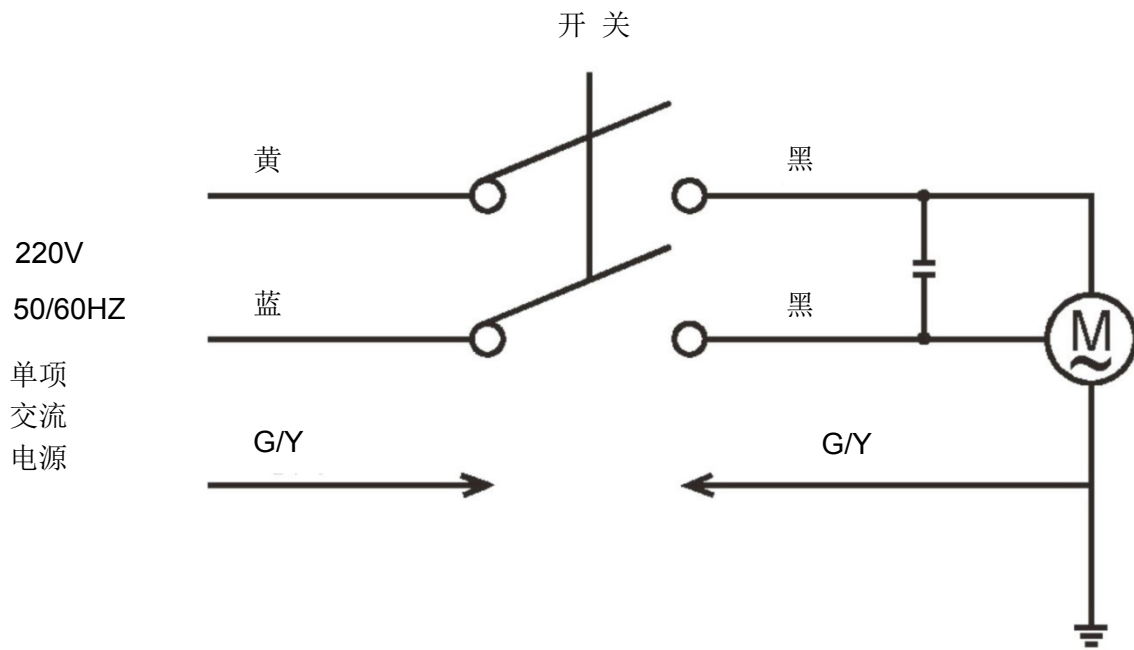

1. CAUTION

Read this manual carefully before starting any operations on this machine.

- 1.1 This apparatus is not prepared to physically weak and the slow response or have mental disorders including children, unless their responsibility for security personnel under the guidance or help the safe use of.
- 1.2 Children should be monitored to ensure they would not play the machine.
- 1.3 Disconnect the plug from the socket before cleaning or repair the machine.
- 1.4 Replace the power cord with one of the same type and specification or repair it if the power cord becomes loose or is damaged.
- 1.5 After the shutdown to disconnect the plug.
- 1.6 Voltage apparatus and the same voltage, frequency of use.

2. PRACTICAL GUIDE FOR THE USER

Read this manual carefully before starting any operations on this machine.

2.1 USE INSTRUCTIONS

- 2.1.1 Make sure that the power supply in the building is identical to that shown on the voltage plate.
- 2.1.2 Assemble suction hose, wards and suitable tool.
- 2.1.3 Connect suction hose to tank connector of vacuum cleaner.
- 2.1.4 Place suction head on tank so that mains cable is opposite to suction hose connection.

2.2 USE-DRY VACUUM CLEANING

- 2.2.1 Make sure that cloth dust bag is always fitted whether a paper filter bag is used or not.
- 2.2.2 Empty dust form tank.

2.3 COMMENT ON SAFETY ATTENTION

- 2.3.1 The machine is not suitable for picking up dusts or liquids which are explosive, inflammable, poisonous or in any way represent a danger to health.
- 2.3.2 Every care must be taken to avoid damaging the mains cable; in care of replacement the same quality of cable must be used.
- 2.3.3 All plugs and sockets sued, must be at least spray water-proof.
- 2.3.4 Never pick-up liquids with dry vacuum cleaner and do not use it out-of-doors.

2.4 CLEANING AND MAINTENANCE ATTENTION! THE MACHINE MUST NOT HAVE CURRENT BEFORE DOING ANY WORK ALWAYS REMOVE THE PLUG

- 2.4.1 Clean tank- do not let it stand for a long time with dust or dirty water.
- 2.4.2 Clean the cloth dust bag thoroughly either by beating or brushing it.
- 2.4.3 From time to time, with a dame cloth, wipe the machine inside and outside as well as the mains cable. Examine at the same time, the outside of the mains cable for cuts or other damage.
- 2.4.4 The cloth dust bag can be washed with a little washing powder in lack warmwater and must be dried again before re-use.

2.4.5 The cloth dust bag should be replaced every 3 to 6 months according to use.

2.5 SUCTION MOTOR MAINTENANCE

The motor is built for maintenance-free running and need not be serviced, The carbon brushes and collector should be checked by a service engineer once a year.

3. TECHNICAL INFORMATION

- **Features**

In a low-noise design, this machine is small, handy and strong in suction. It has multi-purpose attachments that fix to the main unit easily. The product is suitable for families, members' clubs, workshops, factory premises, office buildings and other large-scale public places.

- **Main unit**



GTV-10D

- **Technical Data**

Model	GTV-10D	Vacuum suction	2380mmh ₂ O
Capacity	10L	Cooling mode	Circulating
Working voltage	220V	Tank diameter	345mm
Power	1000W	Height	400mm
Function	Dust vacuuming only	Matching part	Φ32
Air flow rate	210m ³ /h	Power cord	7m

Data can be changed without notice.

- **Standard attachment**

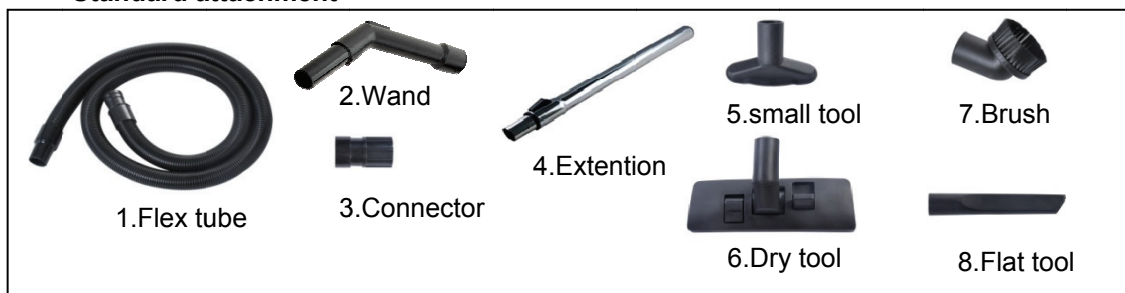

4. Breakdown Figure

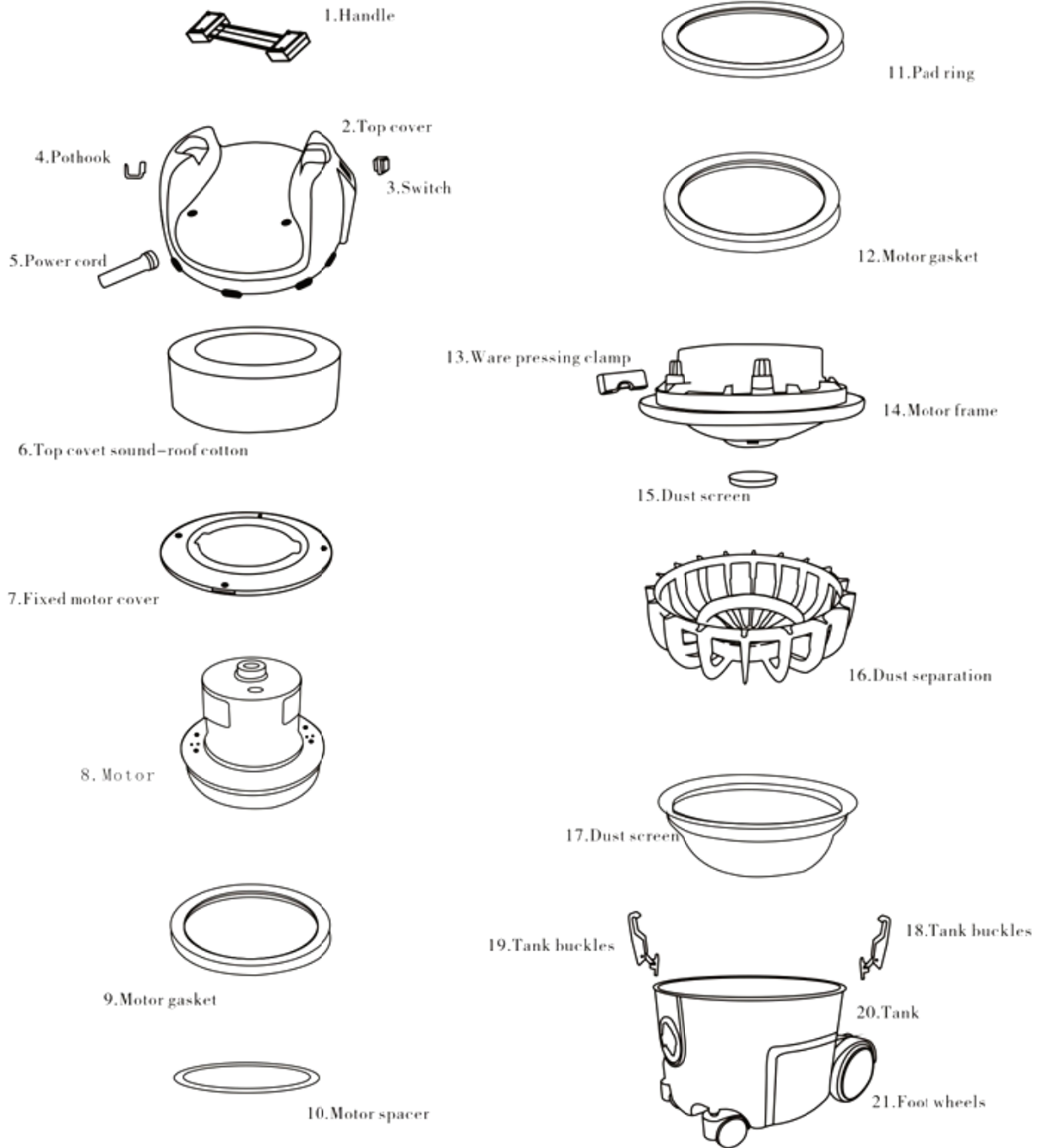

5. Electrical principle Chart



Before carrying out any maintenance operations, unplug the machine from the mains (models with cable) or disconnect the machine connector from the battery connector. All maintenance operations on the electric system and those not explicitly described in this manual must only be performed by trained technical staff in compliance with the safety regulations in force and recommendations stated in the maintenance manual.

! DANGER

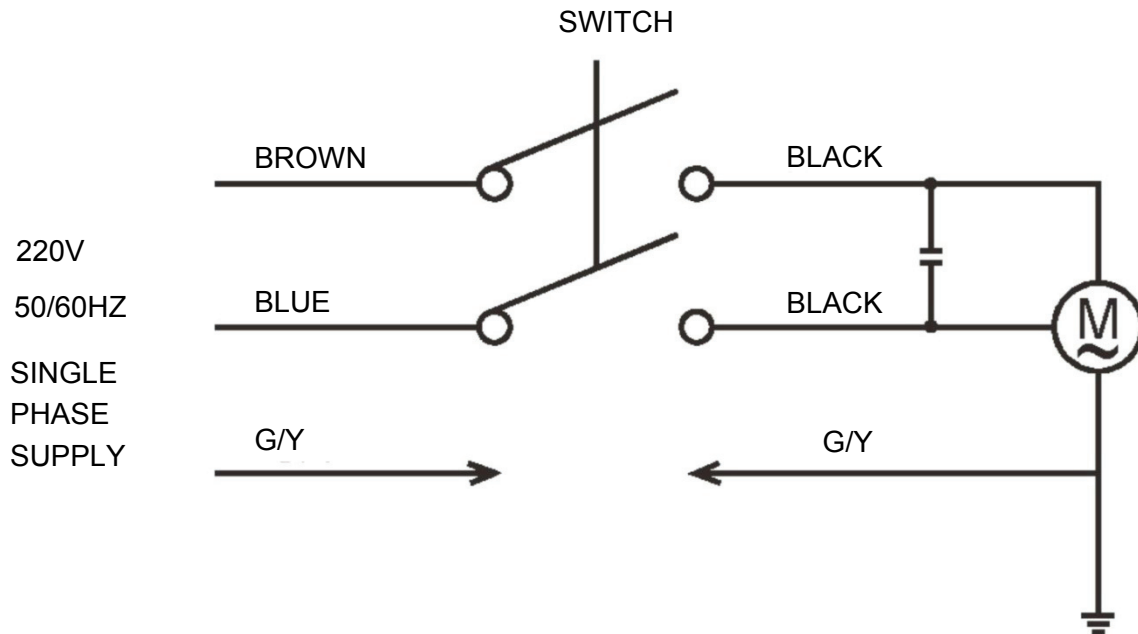



广东嘉得力清洁科技股份有限公司

地址：广东省佛山市南海区桂城瀚天科技城A区7号楼首层

电话：+86 757 81019199 传真：+86 757 81019198

全国服务热线：4008-833-830

Gadlee Green Cleaning Equipment Corporation

1F, Block A, Hantian Industrial Park , Guicheng

Nanhai District, Foshan 528200 Guangdong, China

Tel:+86 757 81019199 Fax:+86 757 81019198

Toll-free: 4008-833-830

[Http://www.gadlee.com](http://www.gadlee.com) E-mail:enquiry@gadlee.com